

# SLC TWIN PRO2

On-line double-conversion UPS 700 VA to 3000 VA

## SLC TWIN PRO2: Advanced on-line protection for sensitive and critical loads

Salicru's **SLC TWIN PRO2** series is a UPS range in a tower format equipped with on-line double-conversion technology and the latest features to make it an advanced protection system for sensitive and critical loads. High output power factor (PF=0.9) to ensure availability to all types of loads.

Full control through status information via LCD display and keypad. And extensive monitoring and communication options via the built-in USB HID interface, an intelligent slot for SNMP cards or relays and a wide range of software packages available – free monitoring version downloadable for Windows, Linux, Unix or Mac and packages available for multi servers or virtualised systems. For facilities that require more back-up time, there is a possibility of backup extensions using UPSs with extra charger and additional battery modules. Also notable is the possibility of Eco-mode operation to improve the efficiency of the device, EPO (emergency power off) functions, operation as a frequency converter and built-in battery test.

Salicru's **SLC TWIN PRO2** range is available in power ratings of 700, 1000, 1500, 2000 and 3000 VA.



## Applications: High-performance features for single-phase environments of up to 3 kVA

Power supply failures in IT systems can cause losses as a result of downtime and the time taken to restore the system to normal operation, and damage to network hardware. Many other disturbances (micro power outages, voltage fluctuations, frequency variations, harmonics, transients, etc.) can also cause IT environments to malfunction.



## Performances

- On-line double-conversion technology.
- Output power factor PF=0.9.
- Control panel with LCD screen and keypad.
- Tower format.
- Backup extensions available for all power ratings.
- UPS models with extra charger for backup extensions.
- USB HID interface for all models as standard.
- Downloadable monitoring software for Windows, Linux, Unix and Mac.
- Intelligent slot for SNMP/relays.
- Eco-mode operation.
- Automatic frequency detector.
- Frequency conversion function.
- EPO – emergency power off.
- Schuko or IEC sockets available.
- Manual and/or automatic programmable battery test.
- Smart battery charger to shorten average recharging times.
- Battery recharging with device turned off.
- SLC Greenergy solution.



## Display

1. Level of battery available.
2. Level of load connected.
3. Operation/alarm/fault status.
4. Input voltage and frequency.
5. Output voltage and frequency.
6. Settings mode.

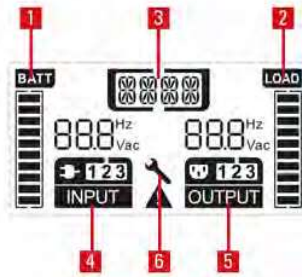

## Communications

- **USBID UPS:** Enables control, parameter configuration and computer shutdown/hibernation via the USB port. Available with Windows, Linux for Mac.
- UPS monitoring and management software for closing files/applications in Windows, Linux, Unix and Mac environments. Free and downloadable from [www.salicru.com](http://www.salicru.com).
- Intelligent slot for connecting SNMP or optocoupler cards.

## Salicru warranty

- Online registration at [www.salicru.com](http://www.salicru.com).
- 2-year warranty.
- Batteries covered by the warranty.
- Telephone technical support.



## Range

MODEL SCHUKO	CODE	POWER (VA / W)	NO. OF SOCKETS	DIMENSIONS (D × W × H mm)	WEIGHT (Kg)
SLC 700 TWIN PRO2	699CA000001	700 / 630	3	356 × 144 × 228	9.2
SLC 1000 TWIN PRO2	699CA000003	1000 / 900	3	356 × 144 × 228	10.2
SLC 1500 TWIN PRO2	699CA000005	1500 / 1350	4	399 × 190 × 327	17.4
SLC 2000 TWIN PRO2	699CA000007	2000 / 1800	4	399 × 190 × 327	18.4
SLC 3000 TWIN PRO2	699CA000009	3000 / 2700	4	399 × 190 × 327	22.7

MODEL IEC	CODE	POWER (VA / W)	NO. OF SOCKETS	DIMENSIONS (D × W × H mm)	WEIGHT (Kg)
SLC 700 TWIN PRO2 IEC	699CA000011	700 / 630	4xC13	356 × 144 × 228	9.2
SLC 1000 TWIN PRO2 IEC	699CA000013	1000 / 900	4xC13	356 × 144 × 228	10.2
SLC 1500 TWIN PRO2 IEC	699CA000015	1500 / 1350	4xC13	399 × 190 × 327	17.4
SLC 2000 TWIN PRO2 IEC	699CA000017	2000 / 1800	4xC13	399 × 190 × 327	18.4
SLC 3000 TWIN PRO2 IEC	699CA000019	3000 / 2700	4xC13 + 1xC19	399 × 190 × 327	22.7

Dimensions and weights for devices with standard backup

## Dimensions

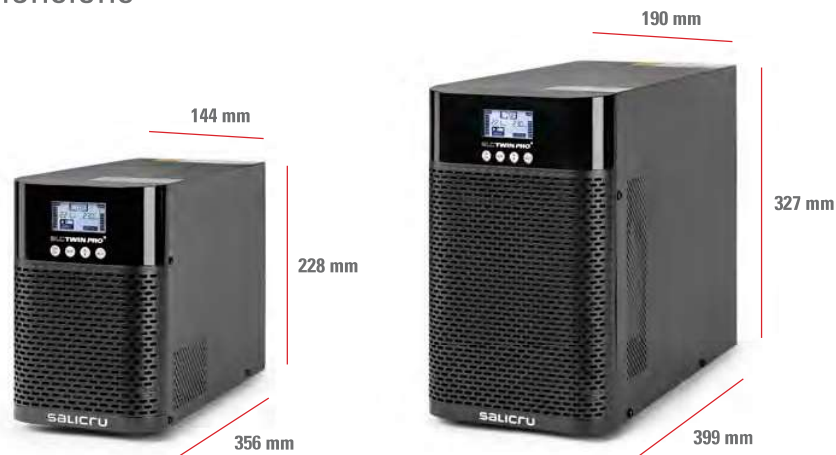

SLC 700/1000 TWIN PRO2 (IEC)

SLC 1500-3000 TWIN PRO2 (IEC)

## Connections

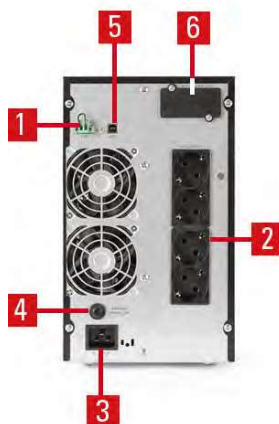

1. Emergency stop (EPO).
2. Socket AC output (SCHUKO / IEC).
3. Socket AC input.
4. Thermal rearmable input.
5. USB HiD interface.
6. Intelligent slot for SNMP/relays.

## Technical specifications

MODEL		SLC TWIN PRO2
TECHNOLOGY		On-line double-conversion
FORMAT		Tower
INPUT	Rated voltage	220 / 230 / 240 V
	Voltage range 100% load	176 ÷ 300 V
	Voltage range 40% load	100 ÷ 300 V
	Rated frequency	50 / 60 Hz
	Frequency range	±10%
	Power factor	≥0.99
	Protection	Resettable circuit breaker
OUTPUT	Power factor	0.9
	Waveform	Pure sine wave
	Rated voltage	220 / 230 / 240 V
	Voltage accuracy	±1%
	Total harmonic distortion (THDv)	<2%
	Synchronised frequency	±10%
	Free running frequency	±0.05 Hz
	Synchronous speed	1 Hz/s
	On-line performance	>89%±92%
	Eco-mode performance	>98%
	Admissible overloads in battery mode	105% constant / 130% for 10 s / 150% for 1 s
	Admissible overloads in bypass mode	130% constant / 180% for 60 s
	Admissible overloads in on-line mode	105% constant / 130% for 60 s / 150% for 10 s / >150% for 300ms
	Available socket formats	Schuko (DIN) o IEC
BATTERY	Battery type	Pb-Ca sealed, AGM, maintenance-free
	Charge type	I/U (constant current/constant voltage)
	Recharge time	4 hours to 90%
	Battery test	Manual and/or automatic programmable
COMMUNICATION	Ports	USB HID
	Intelligent slot	Slot for SNMP/relays
	Monitoring software	For Windows, Linux and Mac
OPERATING MODES	On-line double-conversion	Yes
	Eco-mode	Yes
	Frequency converter (CVCF)	Yes <sup>(1)</sup>
GENERAL	Operating temperature	0° C ÷ 40° C
	Relative humidity	Up to 95%, non-condensing
	Maxium operating altitude	2,400 masl (power degradation up to 5,000 m)
	Acoustic noise at 1 metre	≤49 dB (100% load) / ≤41 dB (60% load)
STANDARDS	Safety	EN 62040-1:2008+A1:2013
	Electromagnetic compatibility (EMC)	EN 62040-2
	Operation	VFI in accordance with EN 62040-3
	Quality and environmental management	ISO 9001 and ISO 14001

(1) up to 60% of the load

Information subject to change without notice.